

DS 6608 Quick Start Guide

Guía rápida de inicio

Guide d'installation rapide

Guida di avvio rapido

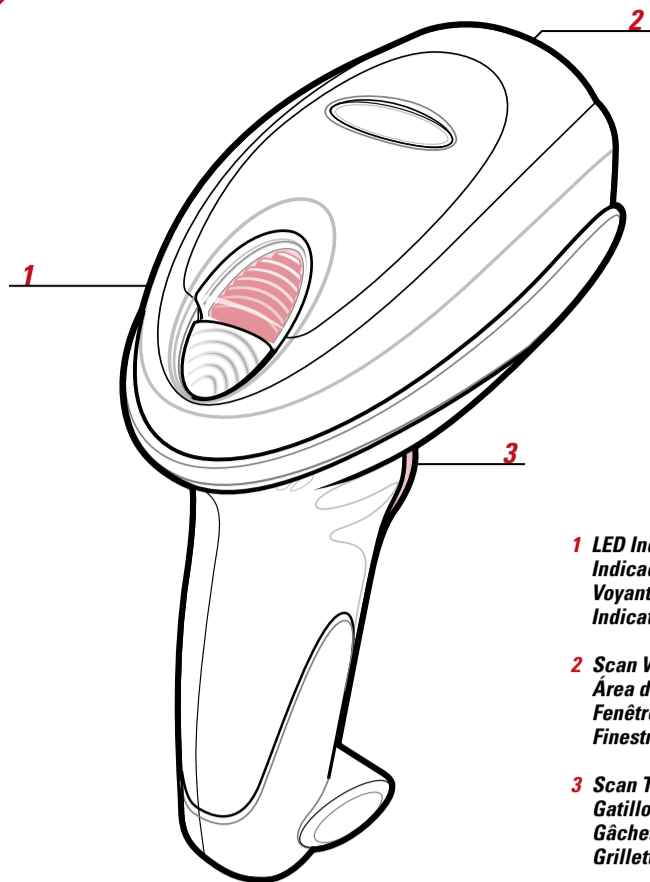
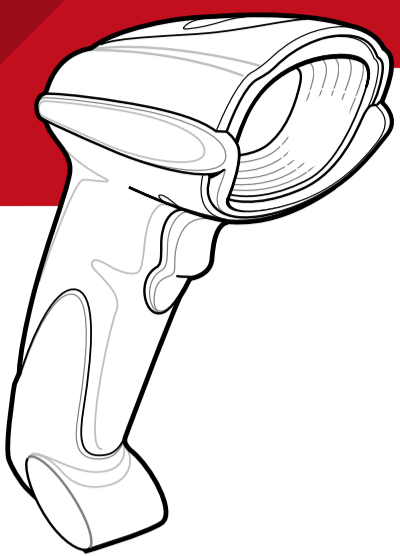

- 1 LED Indicators**
Indicadores LED
Voyants lumineux
Indicatori LED
- 2 Scan Window**
Área de lectura
Fenêtre de lecture
Finestra di scansione
- 3 Scan Trigger**
Gatillo de lectura
Gâchette d'activation
Grilletto di scansione

See Product Reference Guide for more information
Consulte la guía de referencia de producto para obtener más información
Pour plus de détails, voir le Guide de référence produit
Per ulteriori informazioni, consultare la Guida di riferimento del prodotto

Accessories Accesorios

IntelliStand
IntelliStand
IntelliStand
IntelliStand

Accessoires
Desk Cup
Adaptador de escritorio
Adaptateur pour bureau
Supporto per scrivania

Accessori
Wall Mount
Soporte de pared
Montage mural
Montaggio a parete

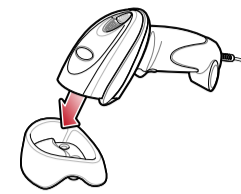
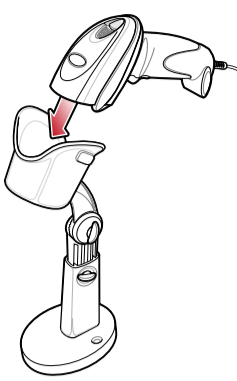

Cord Attachment/Removal Conexión / Desconexión de cable

Connexion/déconnexion du câble Collegamento/Rimozione del cavo

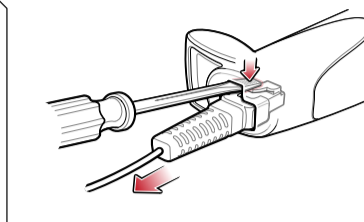
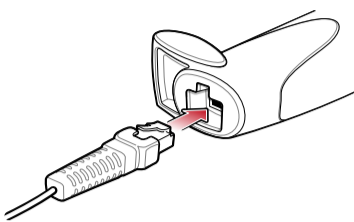

Host Interfaces Interfaces del host

Interfaces hôte Interface host

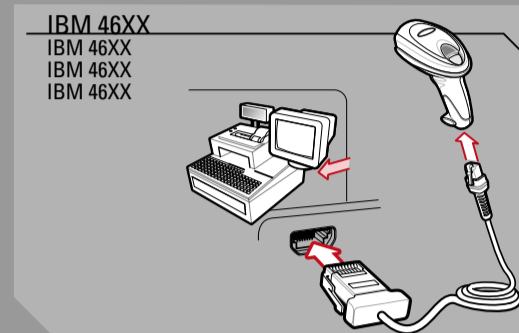
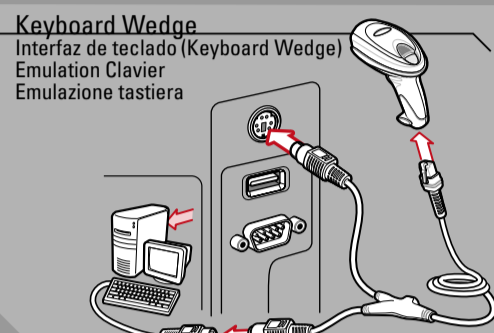
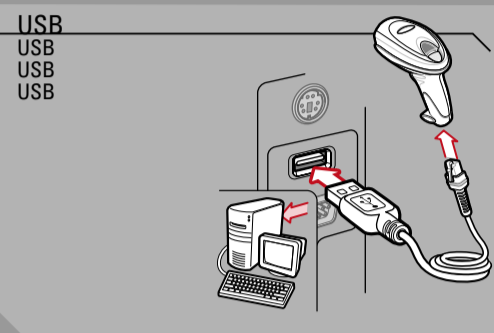
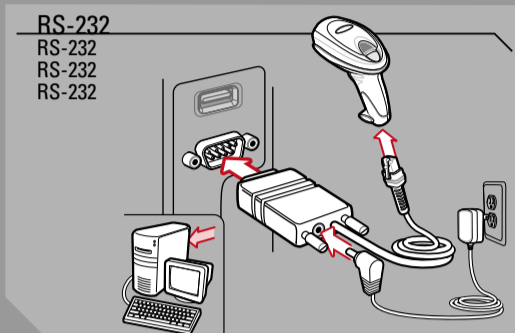

NOTE: Cables may vary depending on configuration.

Nota: Los cables pueden variar dependiendo de la configuración.

Remarque: les câbles peuvent varier en fonction de la configuration.

Nota: i cavi possono variare a seconda della configurazione.

Optimum Scanning Posiciones para lectura óptimas

Lecture optimale Scansione ottimale

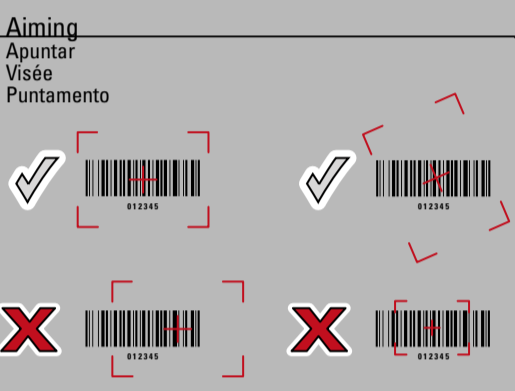

Optimum Arm Position
Posición óptima de brazo
Position optimale des bras
Posizione ottimale del braccio



Avoid Extreme Wrist Angles
Evite Posiciones Forzadas De La Muñeca
Eviter Les Torsions De Poignet
Evitare Di Creare Angoli Estremi Con Il Polso

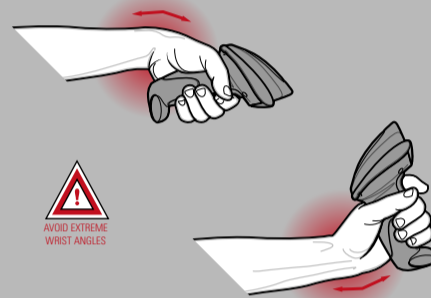

Avoid Bending
Evite Curvar La Espalda
Ne Pas Se Plier
Evitare Di Piegarci

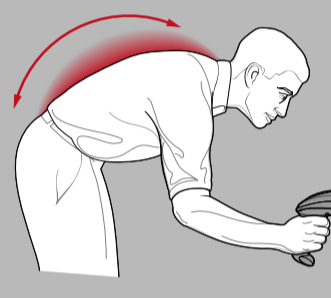

Avoid Reaching
Evite Posturas Forzadas Del Brazo
Ne Pas Tendre Les Bras
Evitare Di Sporgersi

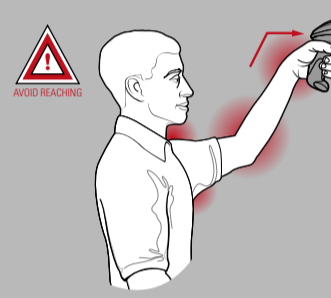

Beeper Indications Indicadores sonoros

Signaux sonores Indicazioni sonore

Standard Use Uso estándar

Low/medium/high beep Bip grave/medio/agudo Volume du bip sonore faible/moyen/élevé Segnale acustico basso/medio/alto	Short medium beep Bip medio breve Volume du bip sonore court d'intensité moyenne Segnale acustico medio e breve	4 long low beeps 4 bips larges y graves 4 bips sonores longs de faible intensité 4 segnali acustici lunghi e di tono basso
Power up Encendido Mettre en marche Accensione	Bar code decoded Lectura de código de barras Code à barres décodé Codice a barre decodificato	Transmission error detected, data is ignored Error de transmisión detectado; la información se omitirá. Erreur de transmission détectée; les données sont ignorées Rilevato errore di trasmissione; dati ignorati

Parameter Menu Scanning Lectura de menú de parámetros

High/low/high/low beep Bip agudo/grave/agudo/grave Volume du bip sonore élevé/faible/élevé/faible Segnale acustico acuto/basso/acuto/basso	High/low beep Bip agudo/grave Volume du bip sonore élevé/faible Segnale acustico acuto/basso	Low/High beep Bip grave/agudo Volume du bip sonore faible/élevé Segnale acustico basso/alto
Successful parameter setting La configuración de los parámetros se ha realizado correctamente Réglage des paramètres effectué Impostazione parametri riuscita	Correct programming sequence performed Secuencia de programación correcta Séquence de programmation correcte effectuée Eseguita sequenza di programmazione corretta	Incorrect programming sequence or 'Cancel' bar code scanned Secuencia de programación incorrecta o código de barras de cancelación leído Séquence de programmation incorrecte ou code à barres 'Cancel' scanné Sequenza di programmazione non corretta o eseguita scansione di codice a barre 'Cancel'

LED Indications Indicaciones LED

Signaux lumineux Indicazioni LED

Off Apagado Éteint Off	Green Verde Vert Verde	Red Rojo Rouge Rosso
Scanner is on and ready to scan, or no power to scanner El lector está encendido y listo para leer o el lector no recibe alimentación Le scanner est en marche et prêt à fonctionner ou il n'est pas allumé Scanner acceso e pronto all'uso o scanner non alimentato	Bar code is successfully decoded Lectura de código de barras correcta Le code à barres a été décodé Decodificado del código a barre riuscita	Transmission error Error de transmisión Erreur de transmission Errore di trasmissione

Troubleshooting Solución de problemas

Dépannage Risoluzione dei problemi

Scanner not working El lector no funciona

Le scanner ne fonctionne pas Scanner non funzionante

No power to scanner El lector no recibe alimentación Le scanner n'est pas alimenté Scanner non alimentato	Incorrect interface cable used Cable de interfaz incorrecto Câble d'interface utilisé incorrect Cavo di interfaccia utilizzato non corretto	Interface/power cables are loose Los cables de interfaz o de alimentación no están bien conectados Les câbles d'interface/d'alimentation ne sont pas bien connectés I cavi di interfaccia/alimentazione sono allentati
Check system power; ensure power supply, if required, is connected Compruebe la alimentación del sistema; asegúrese de que la fuente de alimentación está conectada, si se necesitase Vérifiez l'alimentation; assurez-vous que l'alimentation est connectée le cas échéant Verificare l'alimentazione del sistema; assicurarsi che la sorgente di alimentazione, se necessaria, sia collegata	Ensure that correct interface cable is used Asegúrese de que está empleando el cable de interfaz correcto Vérifiez que le câble d'interface approprié est utilisé Assicurarsi di utilizzare il cavo di interfaccia corretto	Ensure all cable connections are secure Asegúrese de que todas las conexiones están bien establecidas Assurez-vous que tous les câbles sont bien connectés Assicurarsi che i cavi siano saldamente fissati

Scanner decoding bar code, but data not transmitting to host

El lector lee el código de barras, pero el host no recibe los datos
Décodage du code à barres par le scanner, mais aucune donnée n'est transmise à l'hôte
Decodifica del codice a barre in corso. Trasmissione dati all'host non riuscita

Scan appropriate host parameter bar codes Leer códigos de barras de parámetros de host apropiados Lire les codes à barres des paramètres hôte appropriés Eseguire la scansione dei codici a barre dei parametri host pertinenti	Interface cable is loose El cable de interfaz no está bien conectado Le câble d'interface n'est pas bien connecté Cavo di interfaccia allentato
--	--

Scanner not decoding bar code El lector no lee el código de barras

Le scanner ne décode pas le code à barres Scanner non decodifica il codice a barre

Scanner not programmed for bar code type El lector no está programado para el tipo de código de barras Le scanner n'est pas programmé pour ce type de code à barres Scanner non programmato per il tipo di codice a barre	Bar code unreadable Error al leer el código de barras Code à barres illisible Codice a barre non leggibile	Distance between scanner and bar code incorrect Distancia incorrecta entre el lector y el código de barras Distance entre scanner et code à barres incorrecte Distanza errata tra scanner e codice a barre
Ensure scanner is programmed to read type of bar code being scanned Asegúrese de que el lector está programado para leer este tipo de código de barras Assurez-vous que le scanner est programmé pour lire le type de code à barres scanné Assicurarsi che il scanner sia programmato per effettuare la lettura del tipo di codice a barre di cui si sta eseguendo la scansione	Ensure bar code not defaced; try scanning test bar code of same bar code type Asegúrese de que el código de barras no está defectuoso; intente leer un código de prueba del mismo tipo Vérifiez que le code à barres n'est pas défectueux; essayez de lire un code à barres de test de même type Assicurarsi che il codice a barre sia chiaramente leggibile; eseguire una scansione di un codice a barre campione del medesimo tipo	Move scanner closer to or further from bar code Acercar el lector al código de barras o alejarlo Rapprochez ou éloignez le scanner du code à barres Avvicinare o allontanare lo scanner dal codice a barre

Scanned data incorrectly displayed on host

Los datos leídos no se muestran correctamente en el host
Affichage inexact des données scannées sur l'hôte
Dati raccolti visualizzati in maniera errata su host

Scan appropriate host parameter bar codes Leer códigos de barras de parámetros de host apropiados Lire les codes à barres des paramètres hôte appropriés Eseguire la scansione dei codici a barre dei parametri host pertinenti	Interface cable is loose El cable de interfaz no está bien conectado Le câble d'interface n'est pas bien connecté Cavo di interfaccia allentato
--	--

DS 6608 Regulatory Information

Regulatory Information

All Symbol devices are designed to be compliant with rules and regulations in locations they are sold and will be labeled as required.

Any changes or modifications to Symbol Technologies equipment, not expressly approved by Symbol Technologies, could void the user's authority to operate the equipment.

Antenna's, use only the supplied or an approved replacement antenna. Unauthorized antennas, modifications, or attachments could cause damage and may violate regulations.

Laser Devices

Symbol products using lasers comply with US 21CFR1040.10, and IEC825-1:1993, EN60825-1:1994+A11:1996. The laser classification is marked on one of the labels on the product.

Class 1 Laser devices are not considered to be hazardous when used for their intended purpose. The following statement is required to comply with US and international regulations:

Caution: Use of controls, adjustments or performance of procedures other than those specified herein may result in hazardous laser light exposure.

Class 2 laser scanners use a low power, visible light diode. As with any very bright light source, such as the sun, the user should avoid staring directly into the light beam. Momentary exposure to a Class 2 laser is not known to be harmful.

Radio Frequency Interference Requirements

Note: This equipment has been tested and found to comply with the limits for a Class B digital device, pursuant to Part 15 of the FCC rules. These limits are designed to provide reasonable protection against harmful interference in a residential installation. This equipment generates, uses and can radiate radio frequency energy and, if not installed and used in accordance with the instruction manual, may cause harmful interference to radio communications. However there is no guarantee that interference will not occur in a particular installation. If this equipment does cause harmful interference to radio or television reception, which can be determined by turning the equipment off and on, the user is encouraged to try to correct the interference by one or more of the following measures:

- Reorient or relocate the receiving antenna
- Increase the separation between the equipment and receiver
- Connect the equipment into an outlet on a circuit different from that to which the receiver is connected
- Consult the dealer or an experienced radio/TV technician for help.

Radio Frequency Interference Requirements - Canada

This Class B digital apparatus complies with Canadian ICES-003.
Cet appareil numérique de la classe B est conforme à la norme NMB-003 du Canada.

Marking and European Economic Area (EEA)

Statement of Compliance

Symbol Technologies, Inc., hereby declares that this device is in compliance with all the applicable Directives, 89/336/EEC, 73/23/EEC. A Declaration of Conformity may be obtained from <http://www2.symbol.com/doc>

Service Information

Before you use the unit, it must be configured to operate in your facility's network and run your applications.

If you have a problem running your unit or using your equipment, contact your facility's Technical or Systems Support. If there is a problem with the equipment, they will contact the Symbol Support Center.

United States	1-800-653-5350 or 1-631-738-2400
Canada	905-629-7226
United Kingdom	0800 328 2424
Asia/Pacific	+65-6796-9600
Australia	1-800-672-906
Austria/Österreich	1-505-5794-0
Denmark/Danmark	7020-1718
Finland/Suomi	9 5407 580
France	01-40-96-52-21
Germany/Deutschland	6074-49020
Italy/Italia	2-484441
Mexico/México	5-520-1835
Netherlands/Nederland	315-271700
Norway/Norge	+47 2232 4375
South Africa	11-8095311
Spain/España	91 324 40 00 (Inside Spain) +34 91 324 40 00 (Outside Spain)
Sweden/Sverige	84452900
Latin America Sales Support	1-800-347-0178 (Inside US) +1-954-255-2610 (Outside US)
Europe/Mid-East Distributor Operations	
Contact local distributor or call	+44 118 945 7360

For the latest version of this guide go to: <http://www.symbol.com/manuals>.

DS 6608

72-67311-02 Revision A June 2004

<http://www.symbol.com/ds6600>

SYMBOL TECHNOLOGIES, INC. One Symbol Plaza Holtsville, New York 11742-1300

Set Defaults

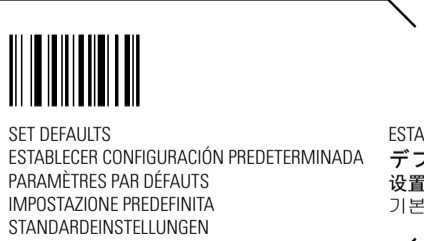

SET DEFAULTS
ESTABLÉCER CONFIGURACIÓN PREDETERMINADA
PARAMÈTRES PAR DÉFAUTS
IMPOSTAZIONE PREDEFINITA
STANDARDEINSTELLUNGEN

ESTABLÉCER CONFIGURACIÓN PRE-DETERMINADA
デフォルト設定
設置默认值
기본값 설정

RS-232 Host Types



STANDARD RS-232
RS-232 ESTÁNDAR
232 STANDARD
STANDARD RS-232
STANDARD RS-232

PADRÃO RS-232
標準 RS-232
标准 RS-232
표준 RS-232
STANDARD RS-232

ICL RS-232 ICL RS-232
ICL RS-232 ICL RS-232
ICL RS-232 ICL RS-232
ICL RS-232 ICL RS-232

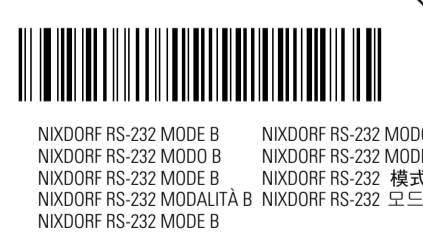

NIXDORF RS-232 MODE B
NIXDORF RS-232 MODO B
NIXDORF RS-232 MODO B
NIXDORF RS-232 MODO B
NIXDORF RS-232 MODALITÀ B
NIXDORF RS-232 모드 B
NIXDORF RS-232 MODE B

USB Host Types

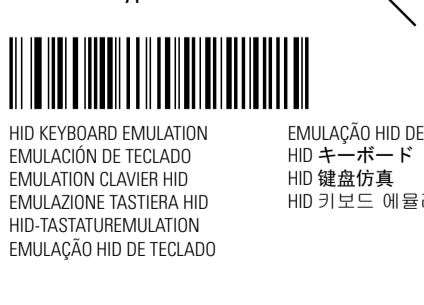

HID KEYBOARD EMULATION
EMULACIÓN DE TECLADO
EMULATION CLAVIER HID
EMULAZIONE TASTIERA HID
HID-TASTATUREMULATION
EMULAZÃO HID DE TECLADO

EMULAZÃO HID DE TECLADO
HID キーボード エミュレーション
HID 鍵盤仿真
HID 키보드 에뮬레이션



ICL RS-232 ICL RS-232
ICL RS-232 ICL RS-232
ICL RS-232 ICL RS-232
ICL RS-232 ICL RS-232

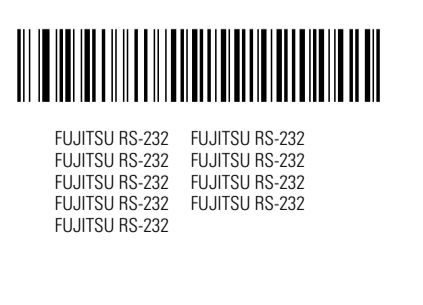

FUJITSU RS-232 FUJITSU RS-232
FUJITSU RS-232 FUJITSU RS-232
FUJITSU RS-232 FUJITSU RS-232
FUJITSU RS-232 FUJITSU RS-232

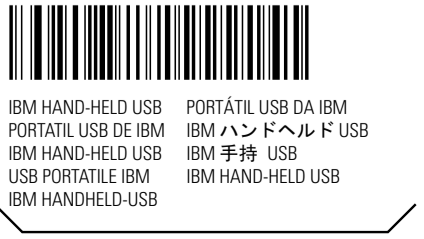

IBM HAND-HELD USB
PORTÁTIL USB DE IBM
PORTATIL USB DE IBM
IBM HAND-HELD USB
USB PORTATILE IBM
IBM HAND-HELD USB
IBM HANDHELD-USB

PORTÁTIL USB DA IBM
IBM ハンドヘルド USB
IBM 手持 USB
IBM HAND-HELD USB

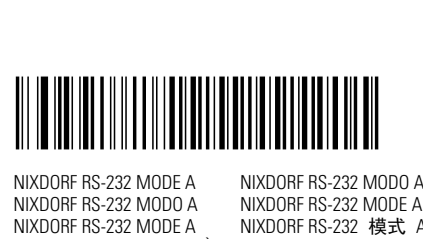

NIXDORF RS-232 MODE A
NIXDORF RS-232 MODO A
NIXDORF RS-232 MODO A
NIXDORF RS-232 MODALITÀ A
NIXDORF RS-232 모드 A
NIXDORF RS-232 MODE A

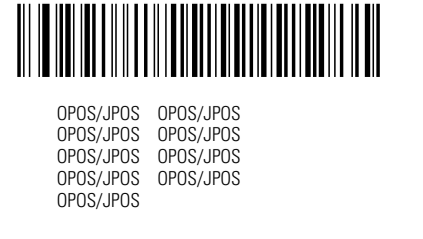

OPOS/JPOS OPOS/JPOS
OPOS/JPOS OPOS/JPOS
OPOS/JPOS OPOS/JPOS
OPOS/JPOS OPOS/JPOS

DS 6608 Kurzübersicht

Guia de Inicialização Rápida クイック スタート ガイド 快速入门指南 사용 설명서

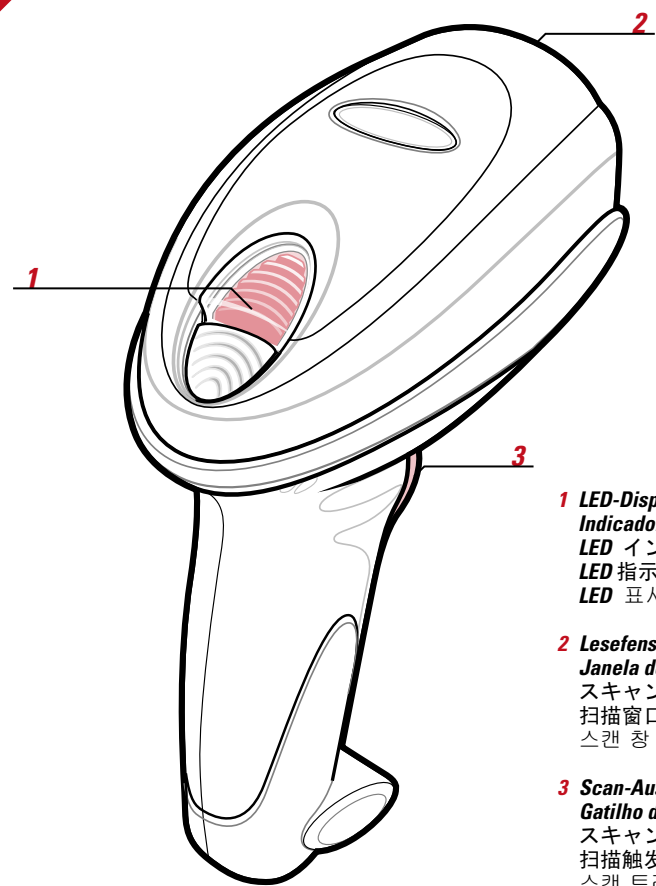
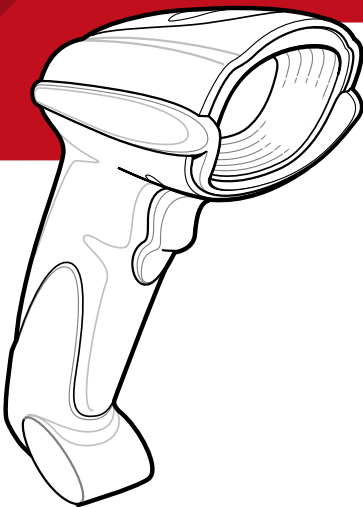

- 1 LED-Displays
Indicadores por LED
LED インジケータ
LED 指示器
LED 표시기
- 2 Lesefenster
Janela de leitura
스캐닝 윈도우
扫描窗口
스캔 창
- 3 Scan-Auslöser
Gatilho de leitura
스캐닝 트리거
扫描触发开关
스캔 트리거

Für weitere Informationen siehe den Product Reference Guide
Consulte o Guia de Referência do Produto para obter mais informações
詳細は、『Product Reference Guide』を参照してください。
其它详细信息，请参阅《产品参考指南》
자세한 내용은 제품 설명서 참조

Zubehör / Acessórios 付属品

- | | | |
|---|--|---|
| IntelliStand
IntelliStand
インテリスタンド
智能支架
인텔리 스탠드 | Tischhalterung
Adaptador de mesa
桌上ホルダー
台式 CUP
책상용 컵 | Wandmontage
Suporte de parede
ウォールマウント
墙面固定
벽면 장착 |
|---|--|---|

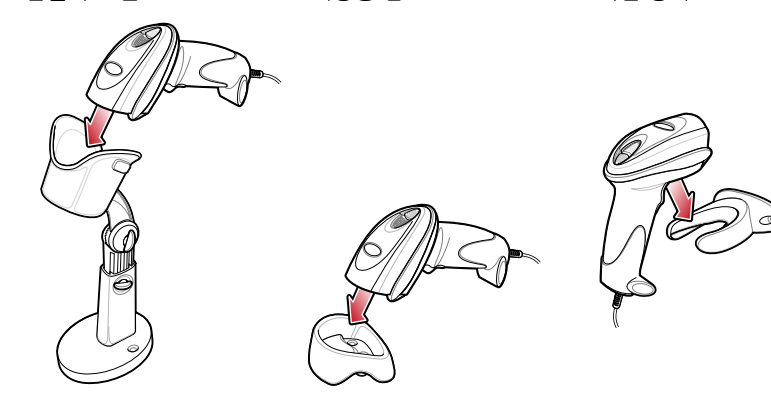

Kabelanschießen/trennen / Conexão do cabo/Remoção

取り外し-付属コード 电线附件/拆除 코드 부착/제거

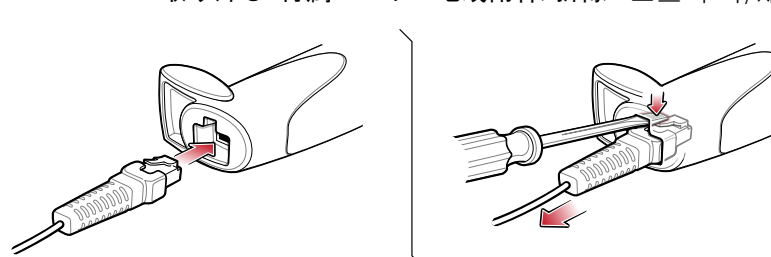

Host-Schnittstellen / Interfaces do host / 호스트 인터페이스

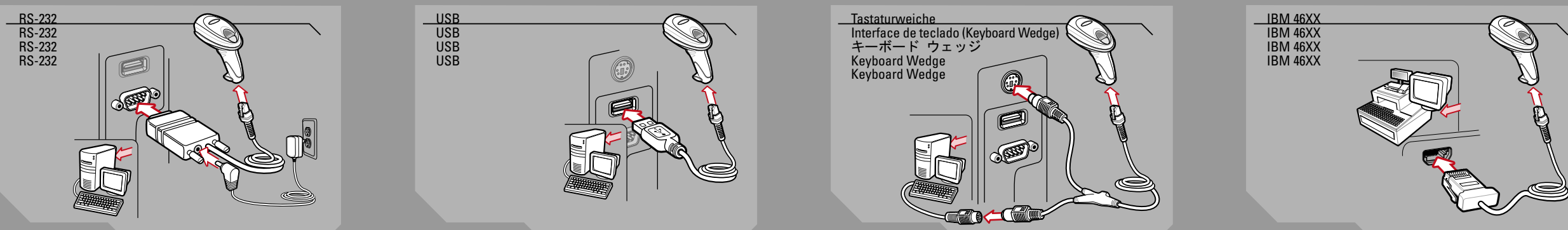

Optimales Scannen / Leitura ideal / 最適な姿勢

<p>Zielen Objetivo 照準 瞄准 조준</p>	<p>Optimale Armposition Posição ideal do braço 最適な肘の位置 最佳手臂位置 최적의 팔 위치</p>	<p>Handgelenk-überdehnung Vermeiden Evitar Torções Extremas De Pulso 手首を極端に曲げないでください。 手腕避免过度弯曲 무리한 손목 각도 금지</p>	<p>Vorbeugen Vermeiden Evite Forçar A Coluna 腰に負担がからぬよう、 注意して作業してください。 避免弯腰 구부림 금지</p>	<p>Überstrecken Vermeiden Evitar Posturas Que Forcem O Braço 無理に腕を伸ばして、 スキャンしないでください。 避免手臂过度抬高 팔 벌림 금지</p>
--	---	--	---	---

Bedeutung der Pieptöne / Indicações SONORAS / बीप音の定義

蜂鸣器指示 경고음 표시

<p>Normalgebrauch / Uso padrão / 標準的な用途</p> <p>Signaltonstellung: leise/mittel/laut Big grave/médio/agudo 低音-中音-高音 ビープ音 저음/중음/고음의 경고음</p> <p>kurzer Signalton mittlerer Lautstärke Big médio e curto 中音の短いビープ音 중음의 짧은 경고음</p> <p>4 lange, leise Signaltöne 4 bigs graves e longos 4 声長而低的蜂鸣声 4번의 긴 경고음</p>	<p>ZWISCHEN LINKER UND RECHTER HAND WECHSELN / PAUSEN EINLEGEN UND AUFGABEN ABWECHSELND AUSFÜHREN</p> <p>ALTERNAR MÃOS ESQUERDA E DIREITA / RECOMENDAM-SE INTERVALOS DE DESCANSO E ALTERNAR AS TAREFAS</p>	<p>Fehlerbehebung / Solução de problemas / 트라블슈어팅</p> <p>Scanner nicht funktionsfähig. O leitor não está funcionando. 스캐너가 작동하지 않습니다.</p> <p>Scanner hat keine Stromversorgung. Leitor sem alimentação. 스캐너에 전원이 공급되지 않음.</p> <p>Falsches Schnittstellenkabel. Cabo de interface incorreto. 올바른 인터페이스 케이블이 사용되지 않음.</p> <p>Schnittstellen-/Netzkaabel lose. Cabos de interface/alimentação frouxos. 인터페이스 케이블이 느슨함.</p> <p>Systemleistung überprüfen. Netzanschluss (falls erforderlich) sicherstellen. Verifique a alimentação do sistema. Verifique se a conexão de rede está sendo usada corretamente.</p> <p>Kabelverbindungen auf Sicherheit prüfen. Verifique se todos os conexões de cabo estão firmes.</p> <p>Scanner nicht auf Barcode-Typ programmiert. O leitor não está programado para o tipo de código de barras. 스캐너가 바코드 디코딩하지 못함.</p> <p>Barcode wird nicht decodiert. O leitor não está decodificando o código de barras. 바코드가 바코드 디코딩하지 못함.</p> <p>Barcode nicht lesbar. Código de barras ilegível. 바코드가 바코드 디코딩할 수 없음.</p> <p>Scanner muss so programmiert sein, dass er den Barcode-Typ lesen kann. Verifique se o leitor está programado para o tipo de código de barras que está sendo lido.</p> <p>Scanner nicht auf richtige Host-Schnittstelle programmiert. O leitor não está programado para a interface de host correta. 스캐너가 호스트 인터페이스가 프로그램되어 있지 않음.</p> <p>Schnittstellenkabel lose. O cabo da interface está frouxo. 호스트 인터페이스 케이블이 느슨함.</p> <p>Scan-Daten falsch auf Host angezeigt. Dados lidos incorretamente mostrados no host. 호스트에 표시된 바코드 데이터가 잘못 표시됨.</p>
---	---	---

Scan-Einstellungen im Parameter-Menü / Leitura do menu de parâmetros / 파라미터 메뉴의 스캐닝

<p>Signaltonstellung: laut/leise/leise/leise Big agudo/grave/agudo/grave 高音-低音-高音-低音 비ープ音 고음/저음/고음/저음의 경고음</p> <p>Signaltonstellung: laut/leise Big agudo/grave 高音-高音 비ープ音 고음/저음의 경고음</p> <p>Richtige Programmsequenz ausgeführt. Sequência de programação correta executada. 올바른 프로그램 시퀀스가 실행되었습니다.</p> <p>Falsche Programmsequenz oder "Cancel". Barcode eingelesen. Sequência de programação incorreta ou código de barras de cancelamento lido. 프로그램 시퀀스가 올바르지 않거나, [キャンセル] 바코드가 스캔되었습니다.</p>	<p>LED-Anzeigen / Indicações por LED / LED 인지케ータ / LED 표시</p> <table border="0"> <tr> <td>Aus / Desligado / 消灯 / 关闭 / 꺼짐</td> <td>Grün / Verde / 綠色 / 绿色 / 녹색</td> <td>Rot / Vermelho / 赤色 / 红色 / 적색</td> </tr> </table> <p>Scanner ist eingeschaltet und bereit zum Scannen, oder Scanner hat keine Stromversorgung. O leitor está ligado e pronto para ler ou está sem alimentação. 바코드가 정상적으로 읽히거나, 스캐너는 전원이 꺼져 있거나, 스캐닝 준비가 되지 않았거나, 전원해 연결되지 않음.</p> <p>Barcode wurde decodiert. Código de barras decodificado com sucesso. 바코드가 성공적으로 디코딩됨.</p> <p>Übertragungsfehler. Erro de transmissão com sucesso. 전송 오류.</p> <p>Barcode für die entsprechenden Host-Parameter scannen. Leia códigos de barras apropriados dos parâmetros do host. 호스트 파라미터에 맞는 바코드를 스캔하십시오.</p> <p>Barcode wird decodiert, jedoch keine Datenübertragung auf Host. O leitor está decodificando o código de barras, mas os dados não estão sendo transmitidos ao host. 바코드는 읽히지만 호스트에 데이터를 전송하지 않음.</p> <p>Scanner nicht auf richtige Host-Schnittstelle programmiert. O leitor não está programado para a interface de host correta. 스캐너가 호스트 인터페이스가 프로그램되어 있지 않음.</p> <p>Schnittstellenkabel lose. O cabo da interface está frouxo. 호스트 인터페이스 케이블이 느슨함.</p> <p>Scan-Daten falsch auf Host angezeigt. Dados lidos incorretamente mostrados no host. 호스트에 표시된 바코드 데이터가 잘못 표시됨.</p> <p>Scanner nicht auf richtige Host-Schnittstelle programmiert. O leitor não está programado para a interface de host correta. 스캐너가 호스트 인터페이스가 프로그램되어 있지 않음.</p> <p>Schnittstellenkabel lose. O cabo da interface está frouxo. 호스트 인터페이스 케이블이 느슨함.</p> <p>Barcode für die entsprechenden Host-Parameter scannen. Leia códigos de barras apropriados dos parâmetros do host. 호스트 파라미터에 맞는 바코드를 스캔하십시오.</p>	Aus / Desligado / 消灯 / 关闭 / 꺼짐	Grün / Verde / 綠色 / 绿色 / 녹색	Rot / Vermelho / 赤色 / 红色 / 적색
Aus / Desligado / 消灯 / 关闭 / 꺼짐	Grün / Verde / 綠色 / 绿色 / 녹색	Rot / Vermelho / 赤色 / 红色 / 적색		

DS 6608 Regulatory Information

©2004 SYMBOL TECHNOLOGIES, INC. All rights reserved.
Symbol reserves the right to make changes to any product to improve reliability, function, or design. Symbol does not assume any product liability arising out of, or in connection with, the application or use of any product, circuit, or application described herein. No license is granted, either expressly or by implication, estoppel, or otherwise under any patent right or patent, covering or relating to any combination, system, apparatus, machine, material, method, or process in which Symbol products might be used. An implied license exists only for equipment, circuits, and subsystems contained in Symbol products. Symbol and the Symbol logo are registered trademarks of Symbol Technologies, Inc. Other product names mentioned in this manual may be trademarks or registered trademarks of their respective companies and are hereby acknowledged.
Symbol Technologies, Inc., One Symbol Plaza, Holtsville, N.Y. 11742-1300, http://www.symbol.com

Patents
This product is covered by one or more of the following U.S. and foreign Patents:
U.S. Patent No. 4,593,186; 4,603,262; 4,607,156; 4,673,805; 4,736,095; 4,758,717; 4,760,248; 4,806,742; 4,816,660; 4,845,350; 4,896,026; 4,897,532; 4,923,281; 4,933,538; 4,992,717; 5,015,833; 5,017,765; 5,021,641; 5,029,183; 5,047,617; 5,103,461; 5,113,445; 5,130,520; 5,140,144; 5,142,550; 5,149,950; 5,157,687; 5,168,148; 5,168,149; 5,180,904; 5,216,232; 5,229,591; 5,230,088; 5,235,167; 5,243,655; 5,247,162; 5,250,791; 5,250,792; 5,260,553; 5,262,627; 5,262,628; 5,266,787; 5,278,398; 5,280,162; 5,280,163; 5,280,164; 5,280,498; 5,304,786; 5,304,788; 5,306,900; 5,324,924; 5,337,361; 5,367,151; 5,373,148; 5,378,882; 5,396,053; 5,396,055; 5,399,846; 5,408,081; 5,410,139; 5,410,140; 5,412,198; 5,418,812; 5,420,411; 5,436,440; 5,444,231; 5,449,891; 5,449,893; 5,468,949; 5,471,042; 5,478,998; 5,479,000; 5,479,441; 5,504,322; 5,519,577; 5,528,621; 5,532,489; 5,543,610; 5,545,889; 5,552,592; 5,557,093; 5,578,810; 5,581,070; 5,589,679; 5,589,680; 5,608,202; 5,612,531; 5,618,028; 5,627,359; 5,637,852; 5,664,229; 5,668,803; 5,675,139; 5,693,929; 5,698,835; 5,705,800; 5,714,746; 5,723,851; 5,734,152; 5,734,153; 5,742,043; 5,745,794; 5,754,587; 5,762,516; 5,763,863; 5,767,500; 5,789,728; 5,789,731; 5,808,287; 5,811,785; 5,811,787; 5,815,811; 5,821,520; 5,823,812; 5,828,050; 5,848,064; 5,850,078; 5,861,615; 5,874,720; 5,875,415; 5,900,617; 5,902,989; 5,907,146; 5,912,450; 5,914,478; 5,917,173; 5,920,059; 5,923,025; 5,929,420; 5,945,658; 5,945,659; 5,946,194; 5,959,285; 6,002,918; 6,021,947; 6,029,894; 6,031,830; 6,036,098; 6,047,892; 6,050,491; 6,053,413; 6,056,200; 6,065,678; 6,067,297; 6,082,621; 6,084,528; 6,088,482; 6,092,725; 6,101,483; 6,102,993; 6,104,626; 6,114,712; 6,115,678; 6,119,944; 6,123,265; 6,131,814; 6,138,180; 6,142,347; 6,172,478; 6,176,428; 6,178,426; 6,186,400; 6,188,681; 6,209,788; 6,209,789; 6,216,951; 6,220,514; 6,243,447; 6,244,513; 6,247,647; 6,308,061; 6,308,061; 6,295,031; 6,308,061; 6,308,892; 6,321,990; 6,328,213; 6,330,244; 6,336,587; 6,340,114; 6,340,115; 6,340,119; 6,348,773; 6,390,949; 6,394,355; 6,395,885; 6,341,584; 6,344,501; 6,359,483; 6,362,453; 6,363,700; 6,363,918; 6,370,478; 6,383,124; 6,391,250; 6,405,077; 6,406,581; 6,414,171; 6,414,172; 6,418,500; 6,419,548; 6,423,468; 6,424,035; 6,430,158; 6,430,159; 6,431,562; 6,436,104.
Invention No. 55,358; 62,539; 69,060; 69,187; NI-068564 (Taiwan); No. 1,601,796; 1,907,875; 1,955,269 (Japan); European Patent 367,299; 414,281; 367,300; 367,298; UK 2,072,832; France 81/03938; Italy 1,138,713 rev. 06/02

Laser Labels

In accordance with Clause 5, IEC 825 and EN60825, the following information is provided to the user:

<p>ENGLISH CLASS 1 CLASS 2</p> <p>CLASS 1 LASER PRODUCT LASER LIGHT DO NOT STARE INTO BEAM CLASS 2 LASER PRODUCT</p>	<p>HEBREW רמת 1 רמת 2</p> <p>מוצר לייזר מסוג 1 מוצר לייזר מסוג 2</p>	<p>DANISH / DANSK KLASSE 1 KLASSE 2</p> <p>KLASSE 1 LASERPRODUKT LASERLYS SE IKKE IND I STRÅLEN KLASSE 2 LASERPRODUKT</p>	<p>ITALIAN / ITALIANO CLASSE 1 CLASSE 2</p> <p>PRODOTTO AL LASER DI CLASSE 1 LUCE LASER NON FISSARE IL RAGGIO/PRODOTTO AL LASER DI CLASSE 2</p>	<p>NORWEGIAN / NORSK KLASSE 1 KLASSE 2</p> <p>LASERPRODUKT, KLASSE 1 LASERLYS IKKE STRIK INN I LYSSTRÅLEN LASERPRODUKT, KLASSE 2</p>	<p>PORTUGUESE / PORTUGUÊS CLASSE 1 CLASSE 2</p> <p>PRODUTO LASER DA CLASSE 1 LUZ DE LASER NÃO FIXAR O RAIÃO LUMINOSO PRODUTO LASER DA CLASSE 2</p>	<p>SPANISH / ESPAÑOL CLASE 1 CLASE 2</p> <p>PRODUCTO LASER DE LA CLASE 1 LUZ LASER NO MIRE FUJAMENTE EL HAZ PRODUCTO LASER DE LA CLASE 2</p>	<p>SWEDISH / SVENSKA KLASS 1 KLASS 2</p> <p>LASERPRODUKT KLASS 1 LASERLJUS STRIKA INTE MOT STRÅLEN LASERPRODUKT KLASS 2</p>	<p>CHINESE / 简体中文 1类 2类</p> <p>1 类激光产品 激光切勿直视光束 2 类激光产品</p>	<p>KOREAN / 한국어 1등급 2등급</p> <p>1 등급 레이저 제품 레이저 광선 이 광선을 주시하지 마십시오. 2 등급 레이저 광선</p>
---	---	--	--	---	---	---	--	--	---

Ergonomic Recommendations

Caution: In order to avoid or minimize the potential risk of ergonomic injury follow the recommendations below. Consult with your local Health & Safety Manager to ensure that you are adhering to your company's safety programs to prevent employee injury.

- Reduce or eliminate repetitive motion
- Maintain a natural position
- Reduce or eliminate excessive force
- Keep objects that are used frequently within easy reach
- Perform tasks at correct heights
- Reduce or eliminate vibration
- Reduce or eliminate direct pressure
- Provide adjustable workstations
- Provide adequate clearance
- Provide a suitable working environment
- Improve work procedures.

Scanner Labeling

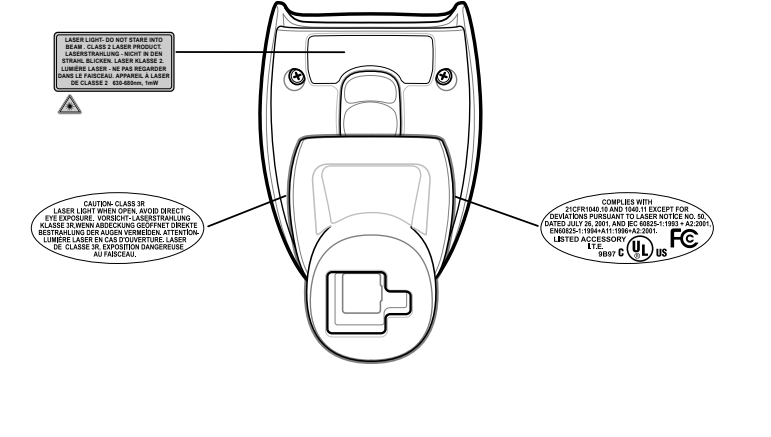

DS 6608 Programming Bar Codes / Programación de código de barras / Codes à barres de paramétrage / Programmazione codici a barra

Barcodes zur Programmierung Programação de códigos de barras バーコードのプログラム 编程条码 바코드 프로그래밍

<p>IBM 46XX Host Types</p> <p>PORT 5B PORTA 5B PUERTO 5B PORT 5B PORTA 5B PORT 5B PORTA 5B PORT 5B PORT 5B</p>	<p>Carriage Return/Line Feed</p> <p><DATA>-SUFFIX 1> <DATA>-SUFFIX 1> <DATA>-SUFFIX 1> <DATA>-SUFFIX 1> <DATA>-SUFFIX 1> <数据>-后缀 1> <DATA>-SUFFIX 1> <DATA>-SUFFIX 1> <DATA>-SUFFIX 1></p>
---	--

Keyboard Wedge Host Types

<p>IBM PC/AT and IBM PC COMPATIBLE PC/AT IBM y PC COMPATIBLE CON IBM COMPATIBLE IBM PC/AT e IBM PC COMPATIBLE PC/AT IBM e PC IBM IBM PC/AT und KOMPATIBEL MIT IBM-PC</p>	<p>COMPATÍVEL COM IBM PC/AT e IBM PC IBM PC/AT e IBM PC 互換機 IBM PC/AT および IBM PC 兼容 IBM PC/AT 및 IBM PC 호환</p>
---	--